

ONE ARCHITECTURE AMSTERDAM

Office Profile

One Architecture is an Amsterdam based architecture and planning firm.

One Architecture is directed by Matthijs Bouw (Amsterdam, 1967), who studied architecture at the TU Delft. During his studies, he designed his first building, the Soest Day Care Center, with four friends. This building was described by critic Bart Lootsma as 'one of the five most important Dutch buildings of the decade'.

Architecture can be much more than building icons or making nice facades. It creates culture. It can help clients make money. It can change organizations. It can even have political impact.

That is why One Architecture wants to do much more than provide professional services and make beautiful projects. One Architecture wants to engage the full complexity of today's society. One Architecture's work integrates design and process. Through an understanding and engagement of the deep structure of planning (stakeholder's agenda's, organizational aspects, technology and program), combined with design intelligence, a diverse range of projects is made.

One Architecture's approach is to involve in an early stage the different disciplines of engineering, programming and costing in order to explore the potential and the feasibility of a project both simultaneously and interdependent.

One Architecture collaborates in a network of specialized consultants. Through their projects, One Architecture has established good relations with advisors in construction, spatial planning, traffic, management, politics and history, both domestically and international.

One Architecture's 15-person team and the tools used are specifically fit for the various disciplines of the office. Director and senior staff are fluent in Dutch, English, French, and German.

Since its foundation, One Architecture has engaged in projects ranging from the design for luxury villas, the urban planning of residential and mixed-use areas to the organization of the Atelier Delta Metropolis for the Dutch Ministry of Spatial Planning.

One Architecture's approach has resulted in successful projects which include the much discussed design for Les Halles in Paris (with OMA and XDKA) in 2004 and urban plans Deventer, Dordrecht, Eindhoven and Tbilisi (Georgia). Recently, the office has been selected for two architectural projects in the United Arab Emirates.

Matthijs Bouw has published, lectured and taught extensively, most recently as the professor i.V. for Gebäudelehre at the RWTH Aachen.

One Architecture Vliegtuigstraat 26 NL - 1059 CL Amsterdam
t +31.20.4 70 00 40 f +31.20.6 76 40 19 office@onarchitecture.nl

ST. JOZEF HEALTH CENTER, DEVENTER

The National monument St. Jozef, a monastery dating from the 1950's is transformed into a health care center. On a programmatic level, the project consists out of eleven independent clusters with sizes from 150 m² up to 700 m², with each their own waiting room for patients and own 'living room' for staff.

RANDSTAD 2040 AND KEY PROJECTS

Randstad 2040 is a design based exploration of the unique urban area, the Randstad, commissioned by the Dutch ministry of spatial planning. The exploration started with Atelier Networks in which One Architecture developed three strategic models, together with external designers. The purpose of the models was to be able to talk about the functionality of the Randstad and the positioning of program and infrastructure. Clear definitions of the models and simple names were chosen deliberately, in order to be able to reach a wide public. As a next step Matthijs Bouw has set up the Atelier Integrations, together with Hilde Blank, Ytje Feddes and Jan Brouwer, in which three pictures of development (based on earlier models) were made.

The exploration was followed up by an exploration of 'Sleutelprojecten' (Key projects) in the Randstad together with OMA and accompanied by the Ministry of Spatial Planning (VROM). Based on this exploration of the current Key Projects the government will possibly start with an integral and substantial exploration of the Key Projects after 2020. Examples of these new projects are: Olympic games, integral safety projects and large scale urban projects on an international level.

OLYMPIC FRAMEWORK

The development of the Olympic framework (Olympische Hoofd Structuur - OHS) is part of the spatial ambition of the Olympic Plan for the Netherlands in 2028 ("a healthy country with plenty sports accommodations and good mobility"). The OHS will serve the purpose of a catalyst for spatial development in the Netherlands. Together with Olympisch Vuur (Olympic fire), stakeholders and experts One Architecture and Zwarts & Jansma Architecten have explored the different issues and will generate ideas. Purpose is to develop a clear idea of the range of possibilities for the spatial planning for the Olympic Structure in the Netherlands, and the measures to be taken for a successful bid. This way the government can quickly make decisions and, after the design phase is finished, implement the Olympic Structure.



COMPLEX URBAN PLANNING

LA DÉFENSE, PARIS

The client, EPAD [Établissement public pour l'Aménagement du quartier d'Affaires de La Défense], launched 4 urban studies in the summer of 2007, within the scope of their Renewal project of a now 50-year-old La Défense. One Architecture took part in the 'Urban Positioning of the Business Center' study.

The goal was to evaluate the image and influence of La Défense on a territorial, regional and international scale. A diagnosis of its strengths, weaknesses and prospects will make it possible to set up a short and long term strategy in order to enhance the brand and the competitiveness of the business district.



LES HALLES, PARIS

In this study with OMA and XDGA, One Architecture worked on the possible restructuring of the Parisian Halles, through a process of consultation and design.

The project includes the reorganization of the infrastructure, the RATP and the subway, and of the shopping mall, the redevelopment of the park and the new development of some 40,000 m² of diverse program.

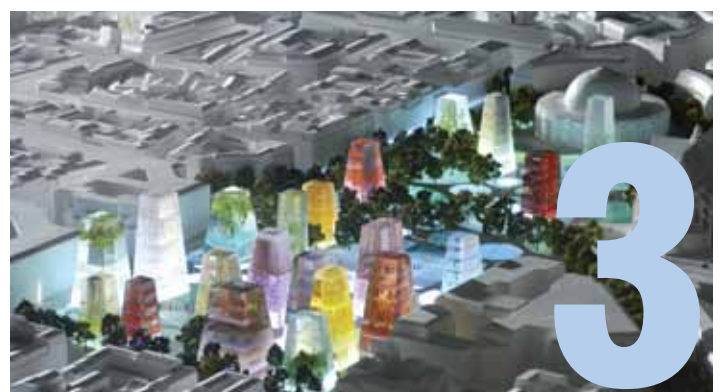

RESTRUCTURING OF BROWNFIELD SITES



LIFESTYLE CENTERS: CINEMA CITY, TBILISI

Cinema City, on the site of the old Georgian filmstudios, is located on a 3 ha site on the axis between the main railway station and the central city. Located 600 meters from the station, the site overlooks the Mtkvari River and on the other side connects to Agmashenebeli Avenue, with its theatres, green open spaces and unique buildings.

Cinema City will be a 'lifestyle center', offering entertainment and restaurants in addition to shopping, residential and office developments and a hotel. Tbilisi's largest supermarket will be located beneath the mall, and will have direct access to parking facilities. The mix of amenities available within the mall will provide "one-stop shopping" for Tbilisi's residents.

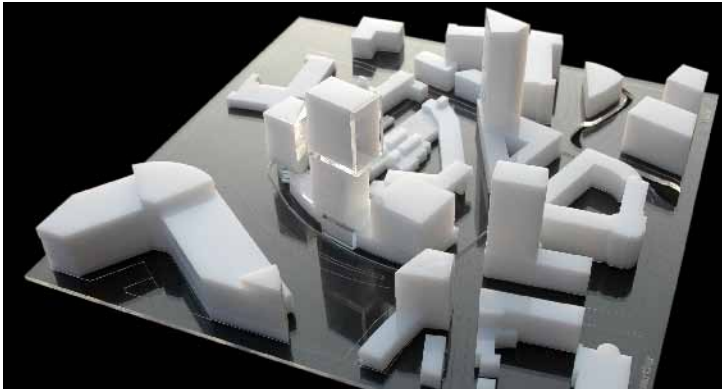

MIXED USE AREAS: VIKTORIAKWARTIER, EINDHOVEN

Former Philips sites are to be transformed into lively city areas. The future Viktoriakwartier is centered on an existing building that houses creative companies/individuals of Eindhoven called TAC (temporary art centre). Besides, a 'young monument' on the north side of the site will be restored. In order to make this operation feasible, new program needs to be added (between 25.000 – 30.000m²) while this addition also needs to contribute to the liveliness of the area.

The urban context of this area is diverse: old small scale existing buildings and a big element: the PSV stadium. The scheme operates as a big block on the big scale and has streets along the TAC that contain small programs like shops, bars, workshops etc. On the west and east sides, plateaus with towers are proposed to accumulate the needed program and to provide good light conditions for the inner streets and patios.



KOP VAN ISSELT, AMERSFOORT

Kop van Isselt in Amersfoort is located on a strategic location close to the city center and in near proximity of highway and train station. Surrounded by several major urban development projects, Kop van Isselt can play a key role in the growth of Amersfoort. Kop van Isselt has unique spatial qualities and a rich industrial history. Key elements in its character are the 'backbone' of the Nijverheidsweg, the connection with Amsterdamseweg and the existing (latent) structures such as the Warner Jenkinson area. Five different perspectives provided insight in the range of possibilities for Isselt. A financial quick scan and tentative schemes for phasing support the perspectives.

URBAN RENEWAL OF PROBLEMATIC LOW INCOME NEIGHBORHOODS

GOUDA

In the past years, Gouda-Oost had become an (undeserved) symbol of the difficulties in new towns. One Architecture was asked to design the urban plan of the renewal.

The Framework for the Zuidelijk Stempel in Gouda Oost is the result of an intensive process together with residents, corporation and municipality. The Framework will form the long-term basis for urban renewal in the next decade. The Framework consists of a strong landscape basis. To get a clear traffic structure, the Zuidelijk Stempel is divided in 2 large squares, which create better connections with the environment. Small, special projects implemented in phases offer a wide range of possibilities for variety of housing types, height, architectural styles and types of outdoor space. (Court)yards between the blocks provide space for safe play, walking and meeting the neighbors. Parking is solved partly on the streets and in the buildings and partly - in the evening and at nights- in the yards. The Oversteek is the central public space in the neighborhood. Sustainability is integral part of the Framework.

